

PBA100-G

solid sprung lever handle  
on rose with stainless steel sub-rose  
stainless steel

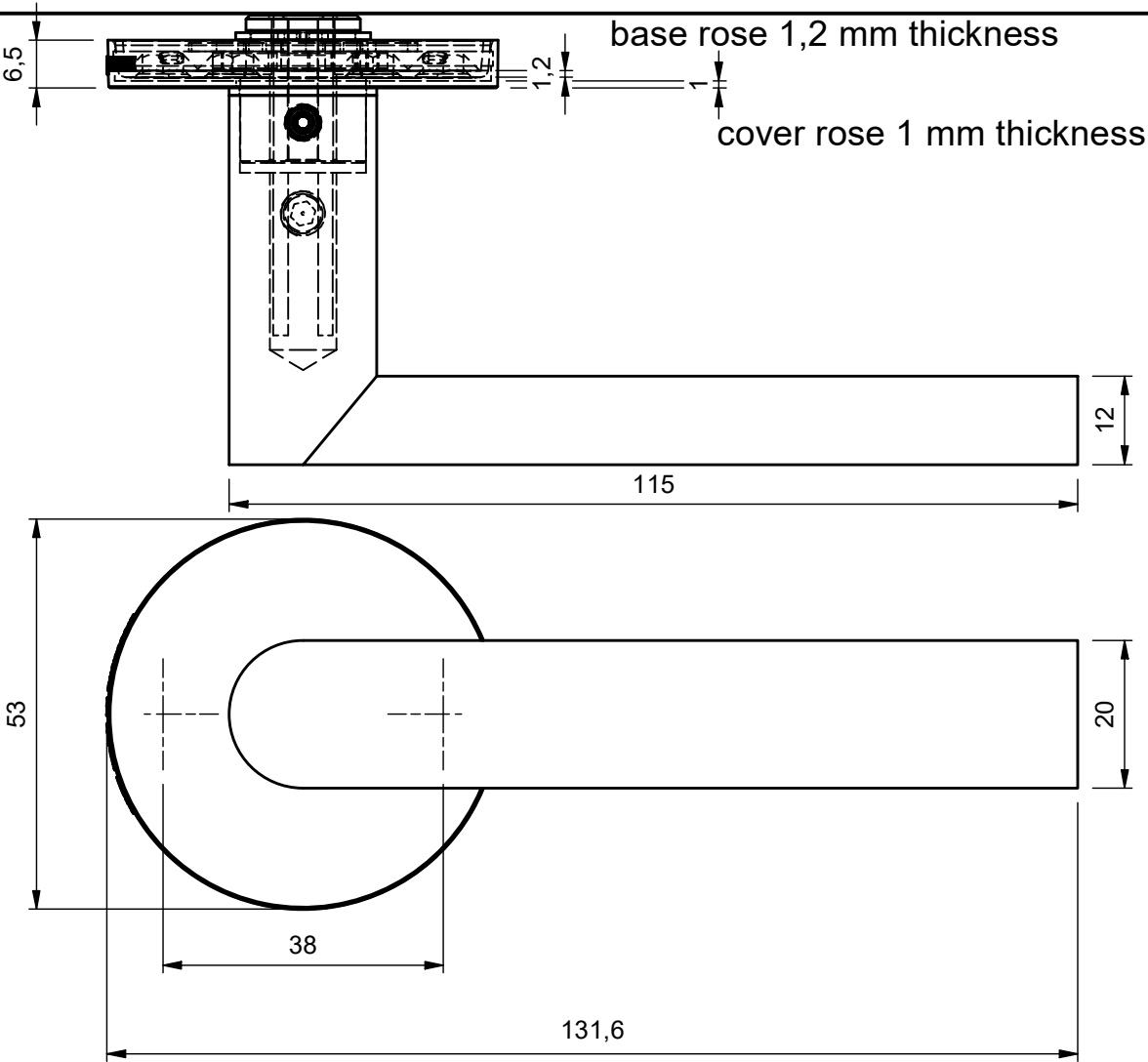
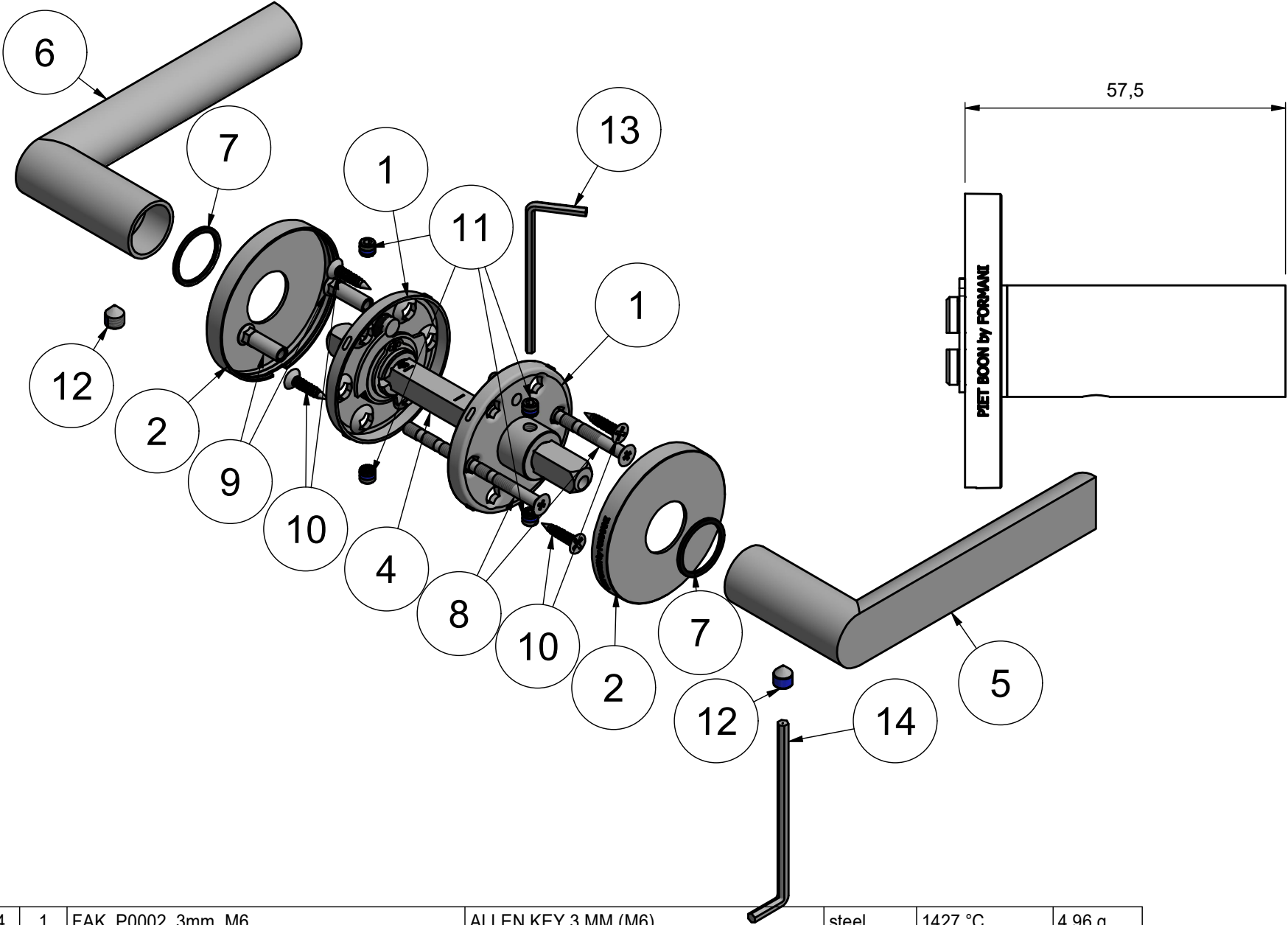

14	1	FAK_P0002_3mm_M6	ALLEN KEY 3 MM (M6)	steel	1427 °C	4,96 g
13	1	FAK_P0001_2,5mm_M5	ALLEN KEY 2.5 MM (M5)	steel	1427 °C	3,11 g
12	2	FGS_P0004_M6x7_G	Grub Screw M6x7 Glue	SS-304	1400-1450 °C	1,02 g
11	4	FGS_P0001_M5x4_GK	Grub Screw M5x4 Knurling with Glue	SS-304	1400-1450 °C	0,52 g
10	4	FSW_P0001	WOOD SCREW CSK DIN97 3.7x14 head diam 7.2	SS-304	1400-1450 °C	0,76 g
9	2	1501B002INNS0_NUT_M4	JF BOOK NUT SS M4 V01	SS-304	1400-1450 °C	1,84 g
8	2	1501B002INNS0_SCREW_M4x60	JF BOOK SCREW SS M4x60 V01	SS-304	1400-1450 °C	6,02 g
7	2	FWH_P0012	WASHER PL OD20xD17x1.0	nylon 6.6	264 °C	0,09 g
6	1	3701D001_2P_PBA100GZR_L_V01	handle without rose L	SS-304	1400-1450 °C	237,27 g
5	1	3701D001_1P_PBA100GZR_R_V01	handle without rose R	SS-304	1400-1450 °C	237,27 g
4	1	FSP_P0005	BB SPINDLE SQ8 L110 ECC	1.0737	1427 °C	47,19 g
2	2	FRC_P0005	COVER ROSE BB 53 SPRING D18 V01 with LOGO LEFT	SS-304	1400-1450 °C	21,26 g
1	2	FRB_P0001	Rose Base Plate	SS-304	1400-1450 °C	18,59 g
Item	Qty	Part number	Description	Material	Melting temp. °C	MASS

FORMANI® FORMANI HOLLAND B.V. EUROPALAAN 12 6199 AB MAASTRICHT-AIRPORT NL T +31 (0)43 308 90 00 INFO@FORMANI.COM WWW.FORMANI.COM	Type :	PBA100	Description: solid sprung lever handle on rose with stainless steel sub-rose stainless steel	Version:
	Formani filename: 3701D001_PBA100G_V01_SET_DETAIL_MASS.dwg			
	Drawn by: Christian Brimbois			
Creation date: 17-11-2022				Format A3

A3