

## Abmessungen und Montageanleitung Schiebetür System - 5075

## Dimensions and installation manual Sliding door system - 5075

Art. Nr.: 29.5075.502.12

Art. Nr.: 29.5075.252.12

### Ausführung:

### Options:

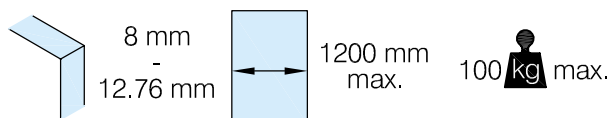

Glas auf Anfrage -  
Nicht Teil des Lieferumfangs!  
Glass upon request -  
Not in scope of supply!

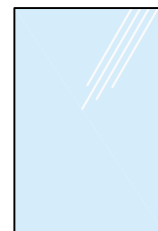

### Im Lieferumfang enthalten - Scope of supply

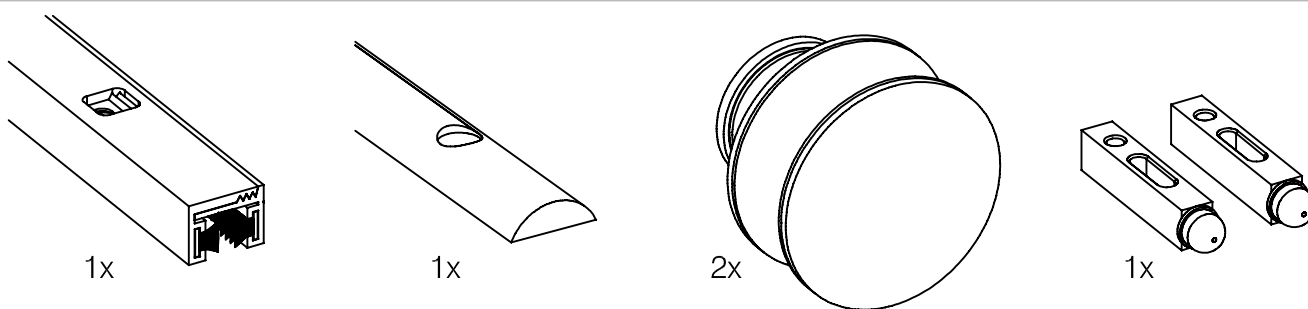

### Montagewerkzeug:

### Mounting tools:

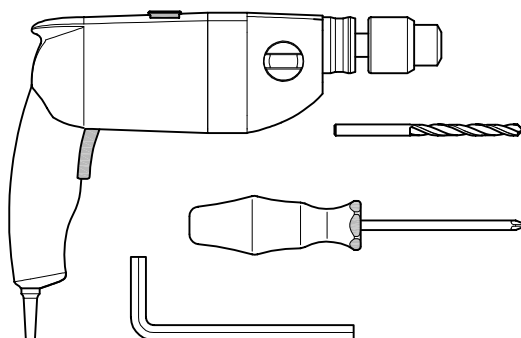

**Wichtig:** Vor der Montage das Glas im Bereich der Klemmfläche mit handelsüblichem Glasreiniger reinigen.  
!!! Keine Verdünnung (Lösemittel) verwenden!

**Important:** The glass clamping area must be cleaned with a standard glass cleaning fluid before install the lock.  
!!! Do not use thinners (solvents)!

## Glass door system

Abmessungen Glastür:

*Glass door dimensions:*

$$G_w = LB + 80 \text{ (min. 580 - max. 1200mm)}$$

$$L = 2500 \text{ mm} / 5000 \text{ mm}$$

$$Gh = LH - 13 \text{ mm}$$

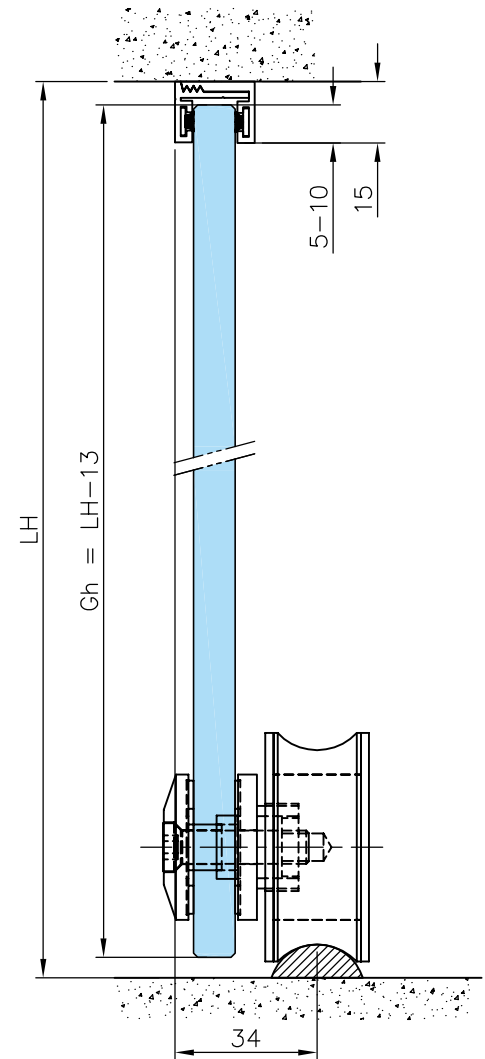
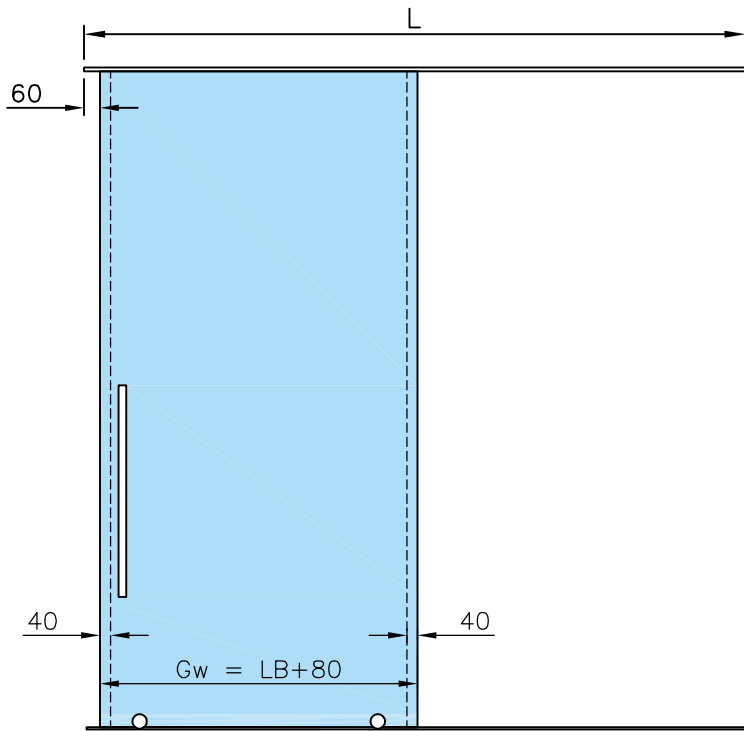

*Glasbohrung:*

*Glass drilled hole:*

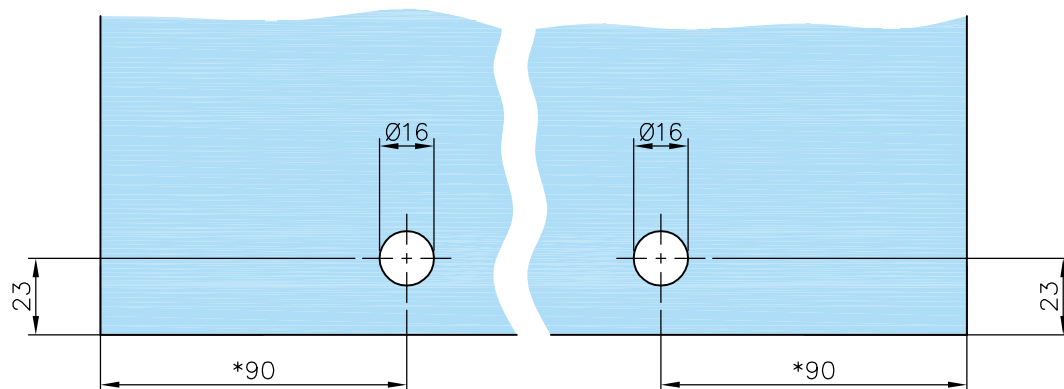

\*Türbreite  $< 800 \text{ mm} = \text{Abstand } 90 \text{ mm}$

Türbreite  $> 800 \text{ mm} = \text{Abstand } 145 \text{ mm}$

\*Door width  $< 800 \text{ mm} = \text{Distance } 90 \text{ mm}$

Door width >800 mm = Distance 145 mm

## Glass door system

1. Profil einstellen und anschrauben:

1. Set profile and fix it:

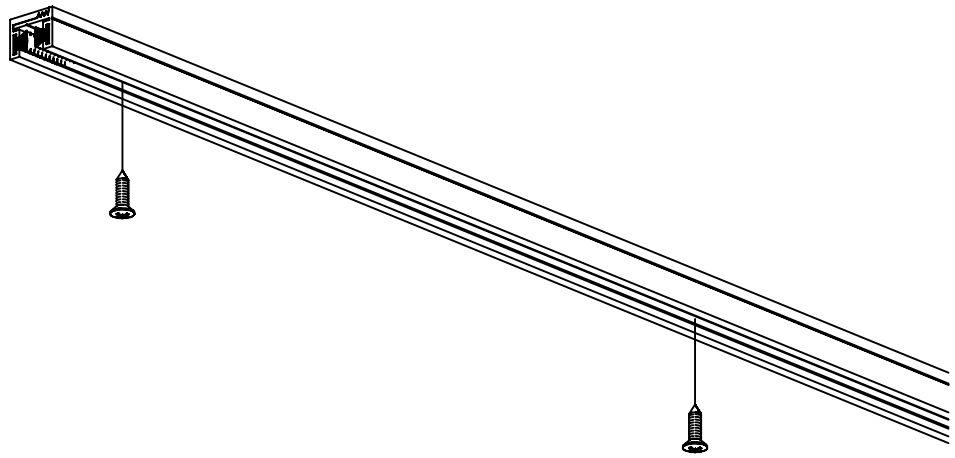
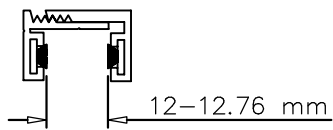
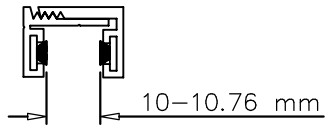
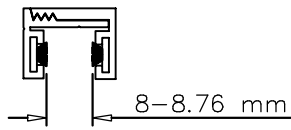

2. Edelstahlleiste nach Maßangabe anbringen:

2. Install the stainless steel strip as required:

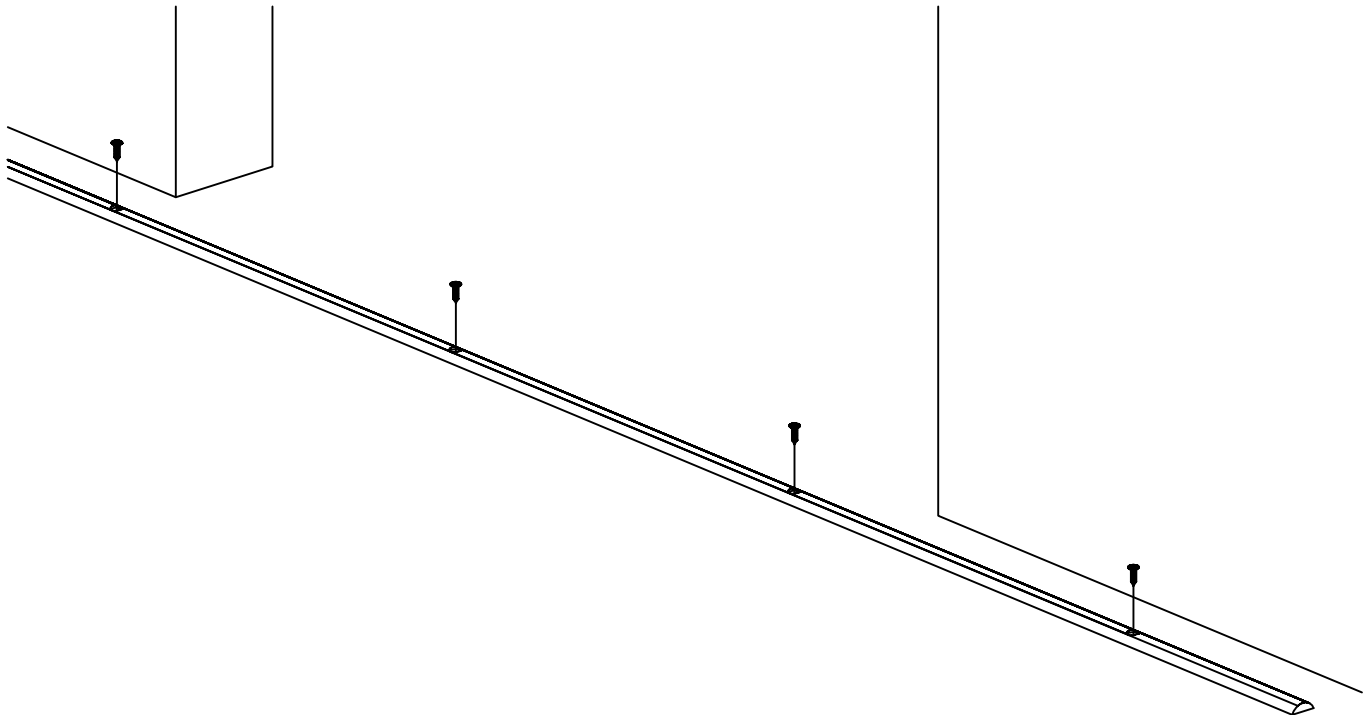

## Glass door system

3. Laufrolle an das Glas anbringen:

3. Install the roller on glas:

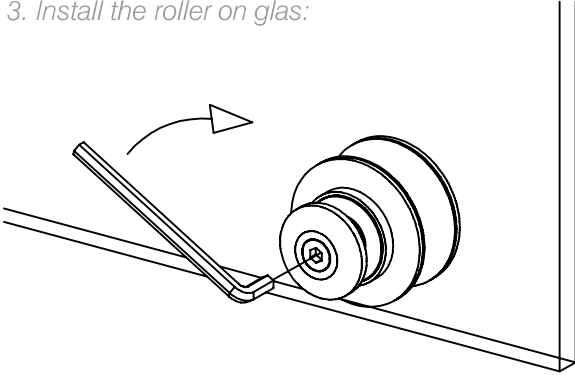

4. Glas ins Profil von der Seite einschieben.:

4. Insert the glass into the profile from the side:

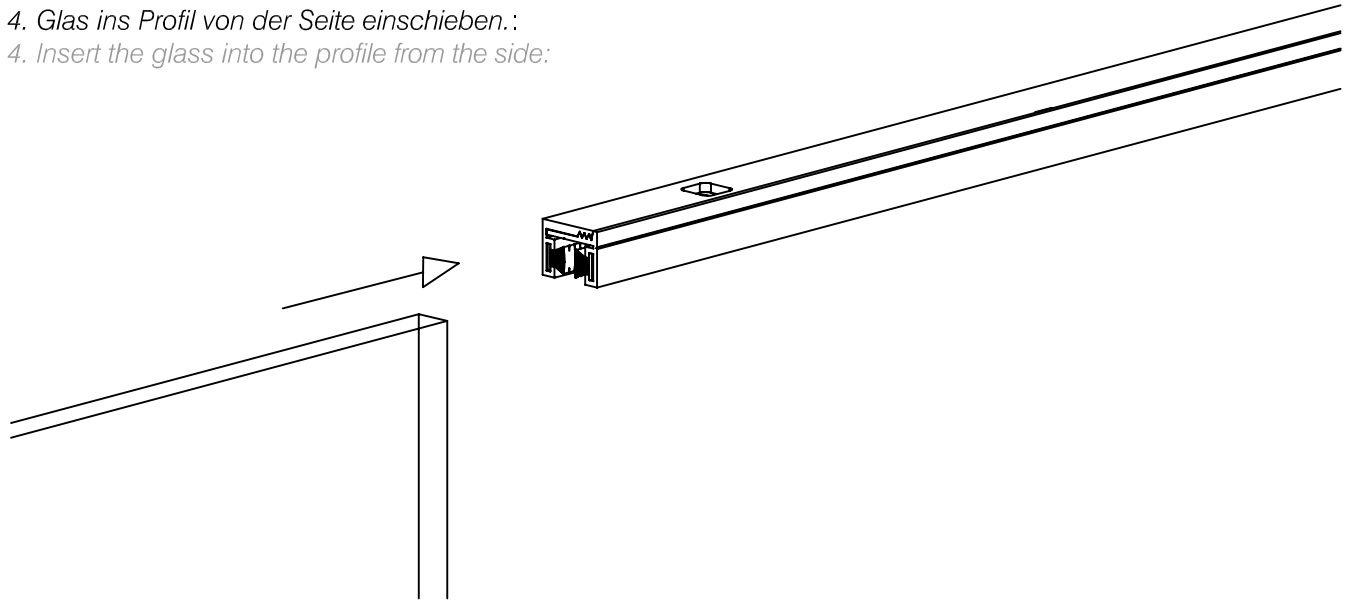

4. Höhe mit Hilfe der Laufrolle einstellen:

4. Adjust the height using the roller:

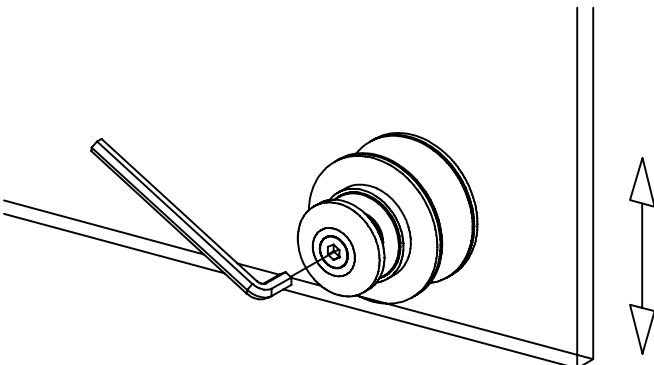

Exzenterring  
eccentric-ring



Höhenvertellbar  
height adjustment

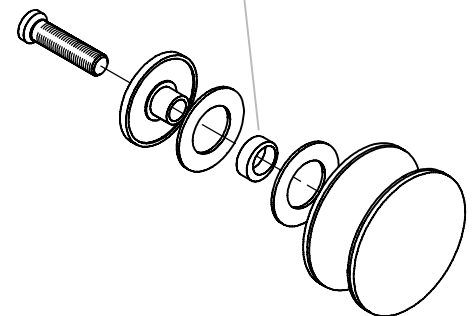

5. Stopper anbringen:

5. Install the stopper:

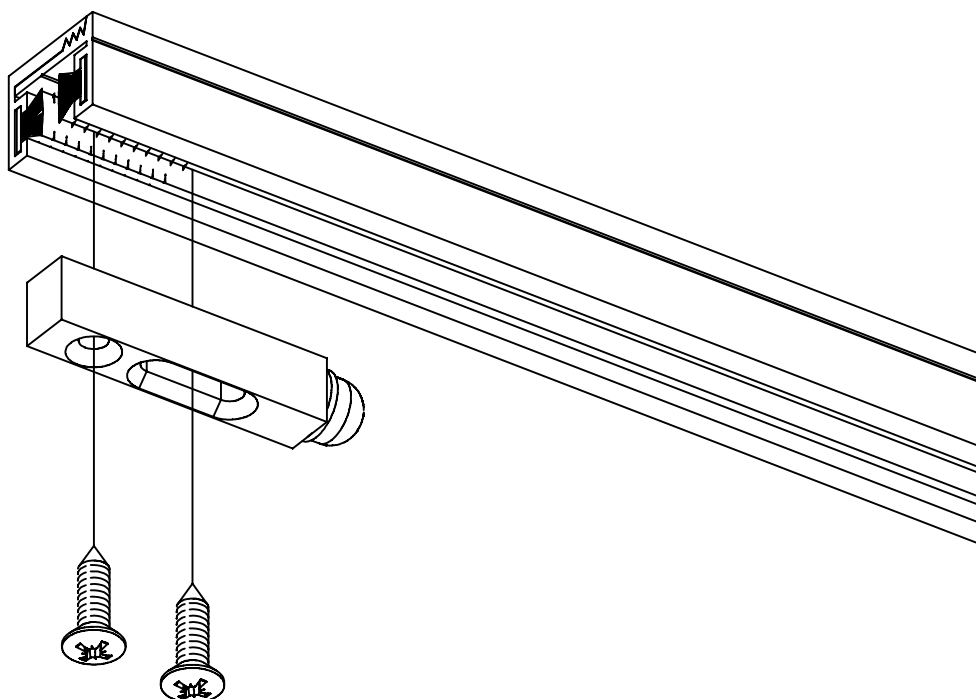

6. Optional, können Glasausschnitte gemacht werden:

6. Optionally, glass cutouts can be made:

