

Technische Daten:
Schiebetür - 5131
Datasheet:
Sliding door - 5131

Art. 29.5131.251.12	Art. 29.5131.251.26
Art. 29.5131.252.12	Art. 29.5131.252.26
Art. 29.5131.253.12	Art. 29.5131.253.26

Ausführung:
Options:

Glas auf Anfrage -
 Nicht Teil des Lieferumfangs!
 Glass upon request -
 Not in scope of supply!

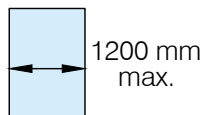
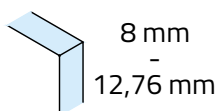

Material: V2A
Material: Stainless steel AISI 304

Gewicht: / Weight: 4,7 kg

Oberfläche: Edelstahl-Design
Finish: stainless steel design

Anthrazit-Design
anthracite design
Im Lieferumfang enthalten:
Scope of supply:

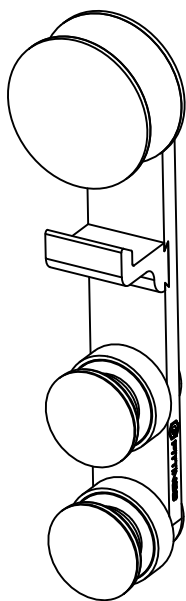
2x 46.6130.000.12



1x 46.6122.000.12

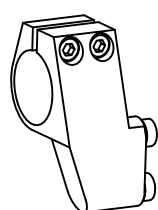

1x 46.6123.000.12

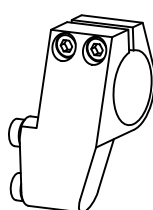

1x 12.8925.025.12

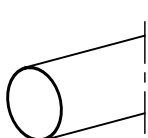

1x 46.6109.000.12

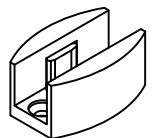

1x 91.0010.003.03

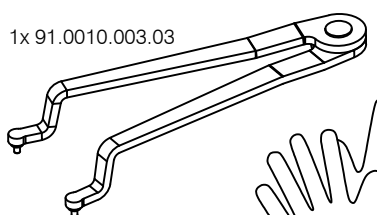

1x 19.1330.005.00

1x 19.0700.000.00

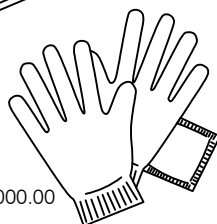

29.5131.251.12

5x 46.6117.000.12

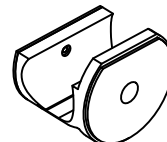

2x 11.0732.025.20



29.5131.252.12

5x 46.6116.000.12

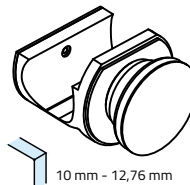

1x 11.0500.025.20

1x 11.0732.025.20

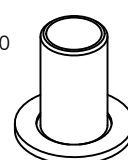

29.5131.253.12

5x 46.6116.000.12

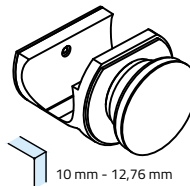

2x 11.0732.025.20

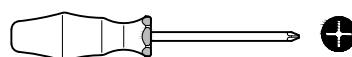
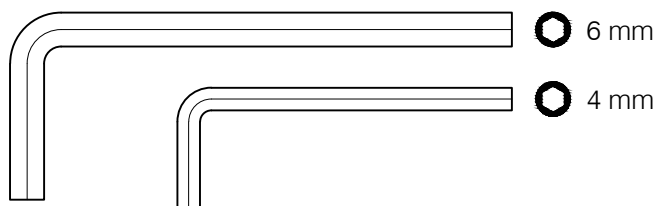
Montagewerkzeug:
Mounting tools:

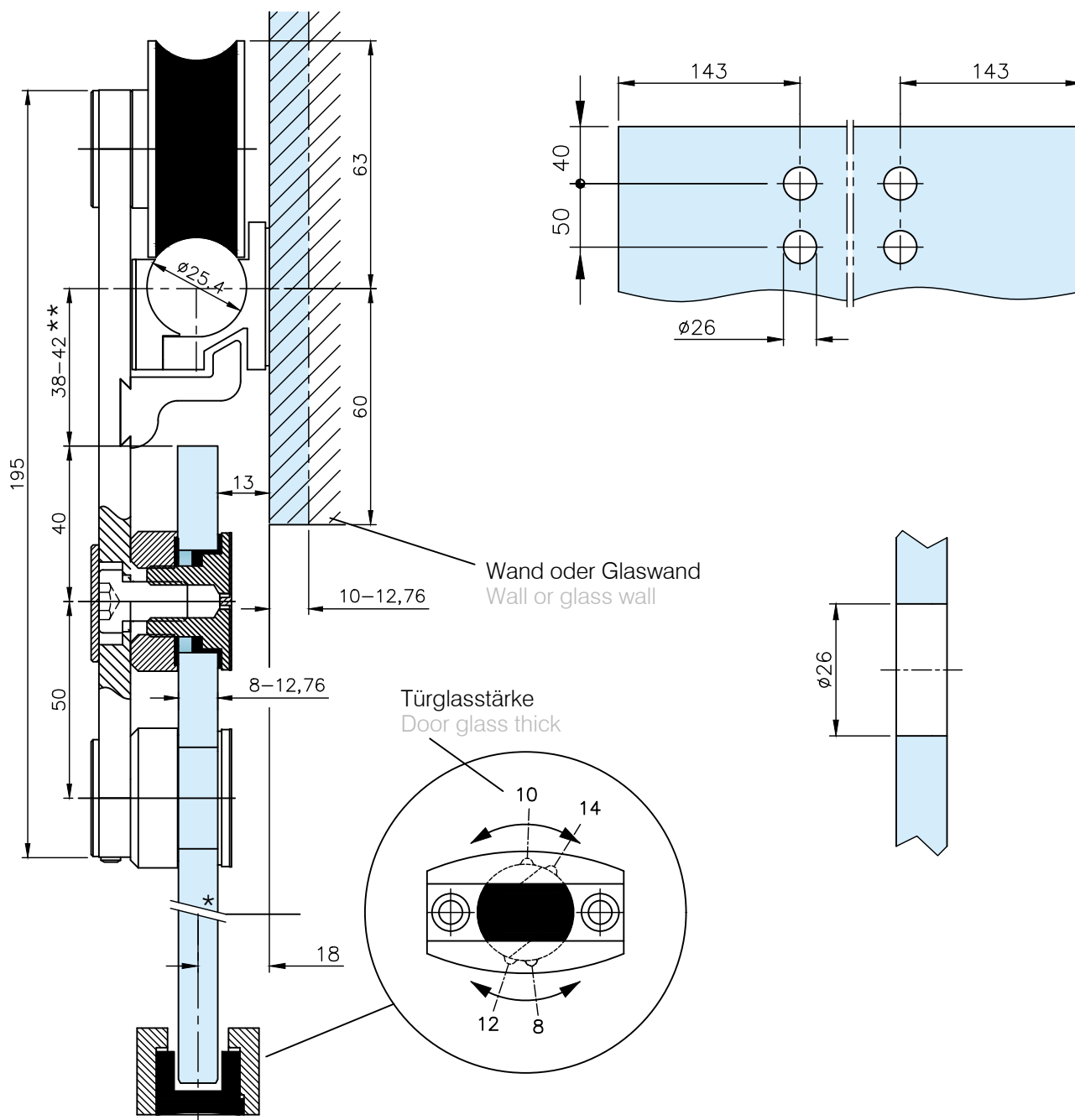

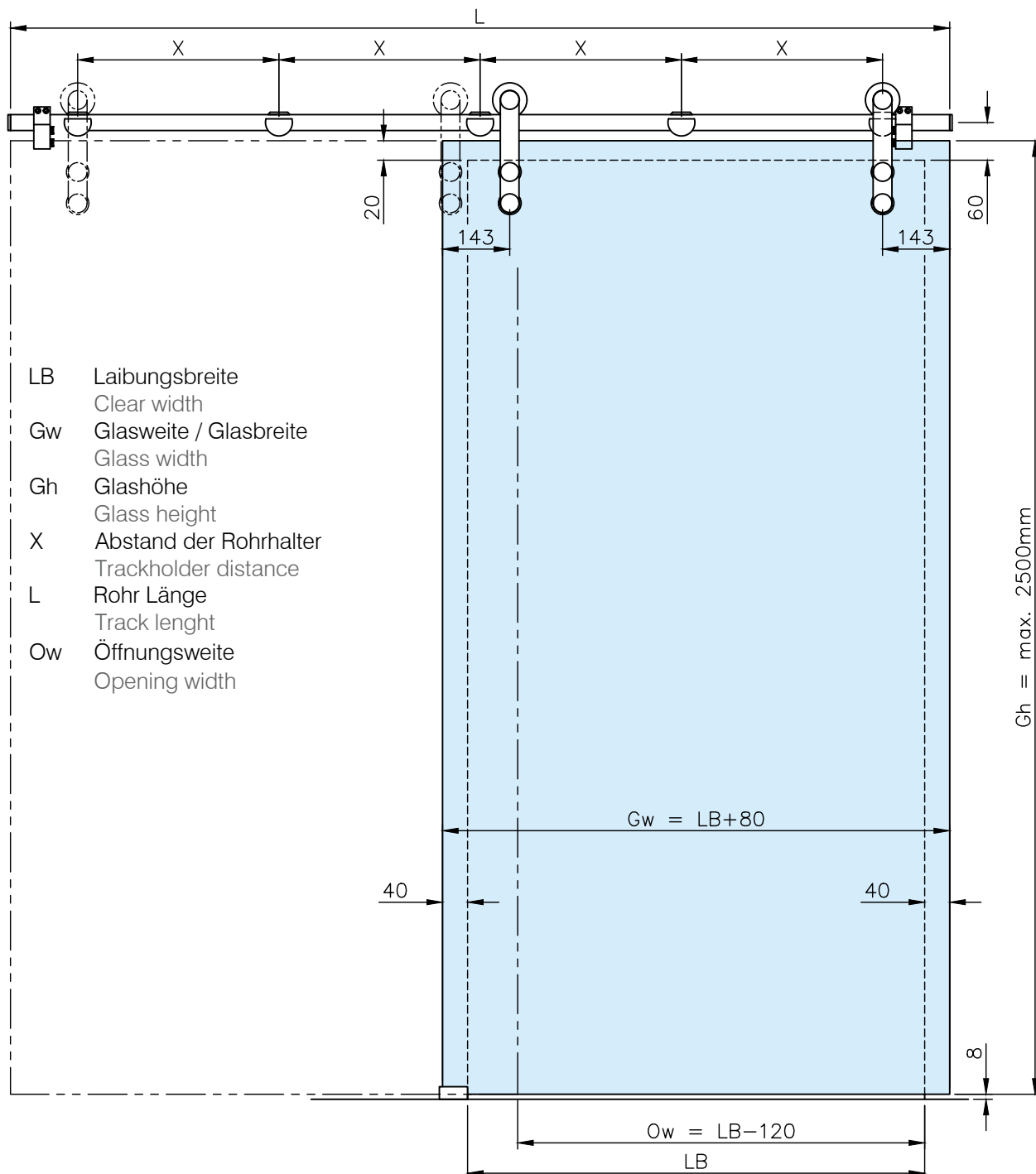

Wichtig: Vor der Montage das Glas im Bereich der Klemmfläche und Glasbohrung reinigen.
Wir empfehlen G-Fittings Glasreiniger art. 91.1800.000.00 - (Keine Verdünnung/Lösemittel verwenden!)

Important: The glass clamping and drill hole area must be cleaned before installation.
We recommend G-Fittings glass cleaner art. 91.1800.000.00 - (Do not use thinners/solvents)!

Nur Wand Montage
Only wall installation

Art. 29.5131.251.12
Art. 29.5131.251.26

Stand 02.2022

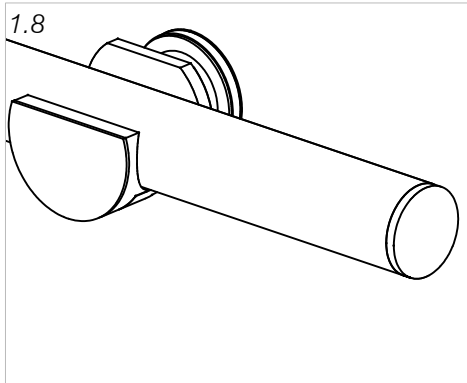
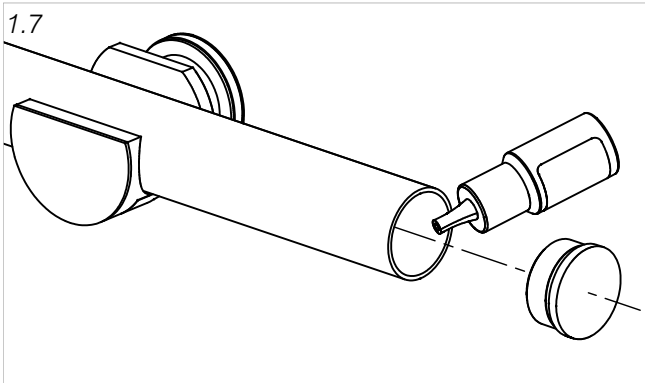
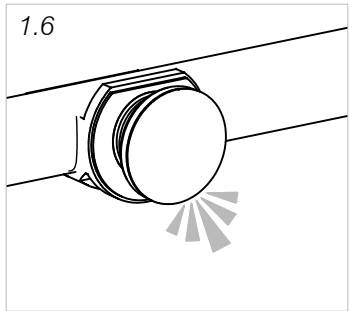
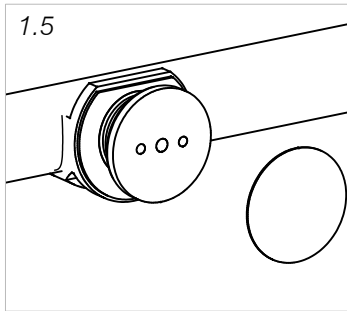
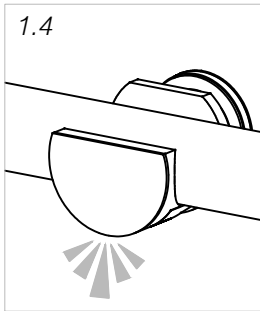
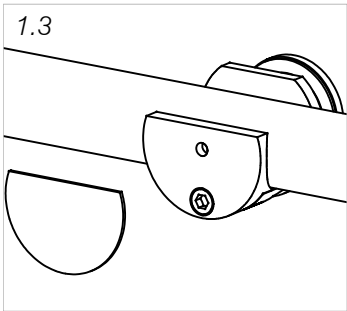
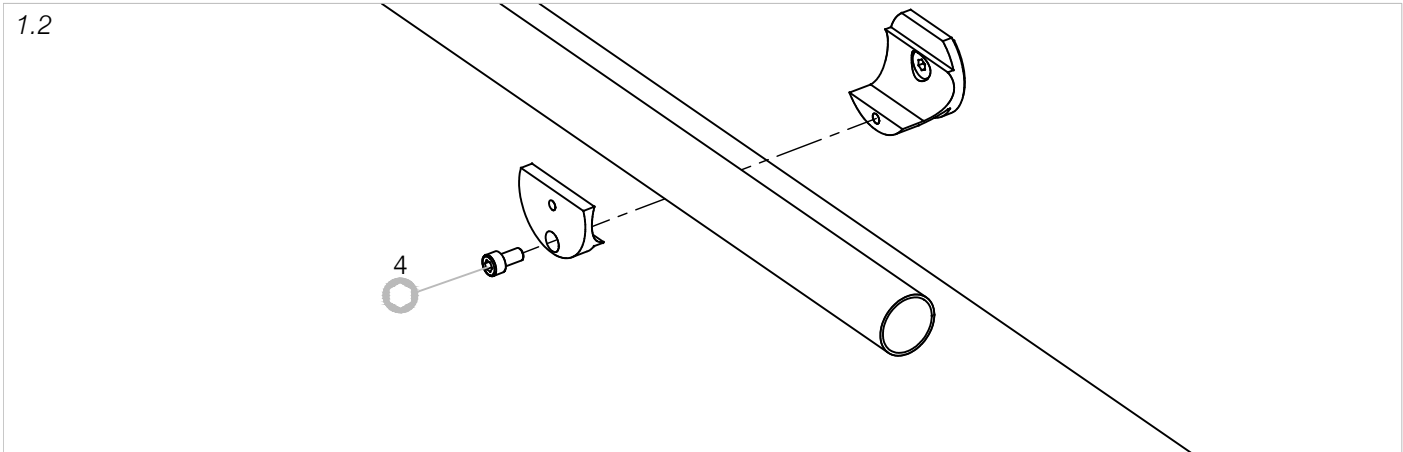
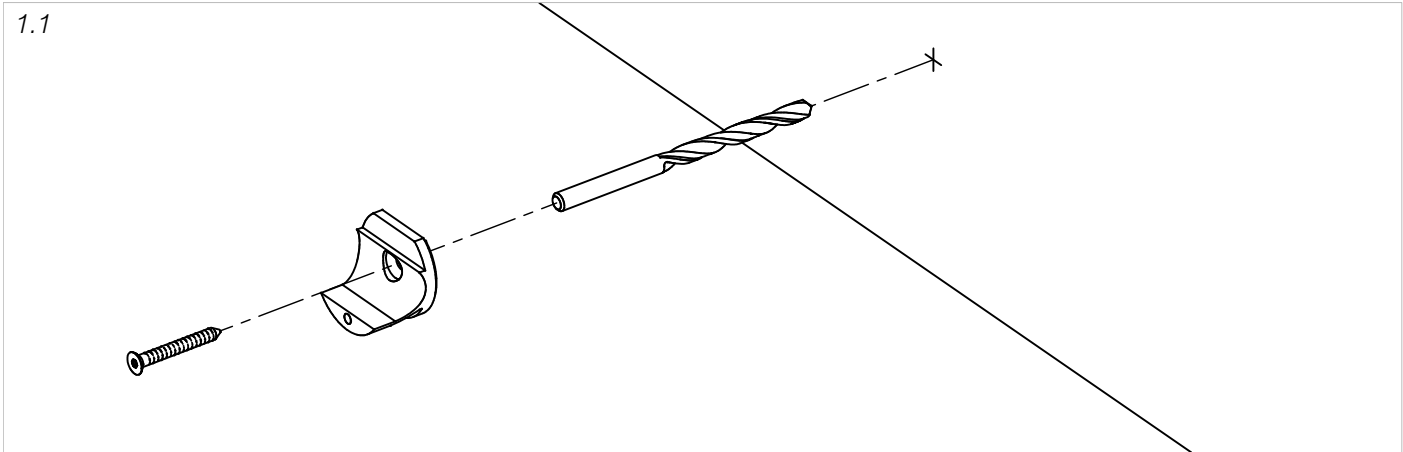

Nur Wand/Glas Montage
Only wall/glass installation

Art. 29.5131.252.12
Art. 29.5131.252.26

Stand 02.2022

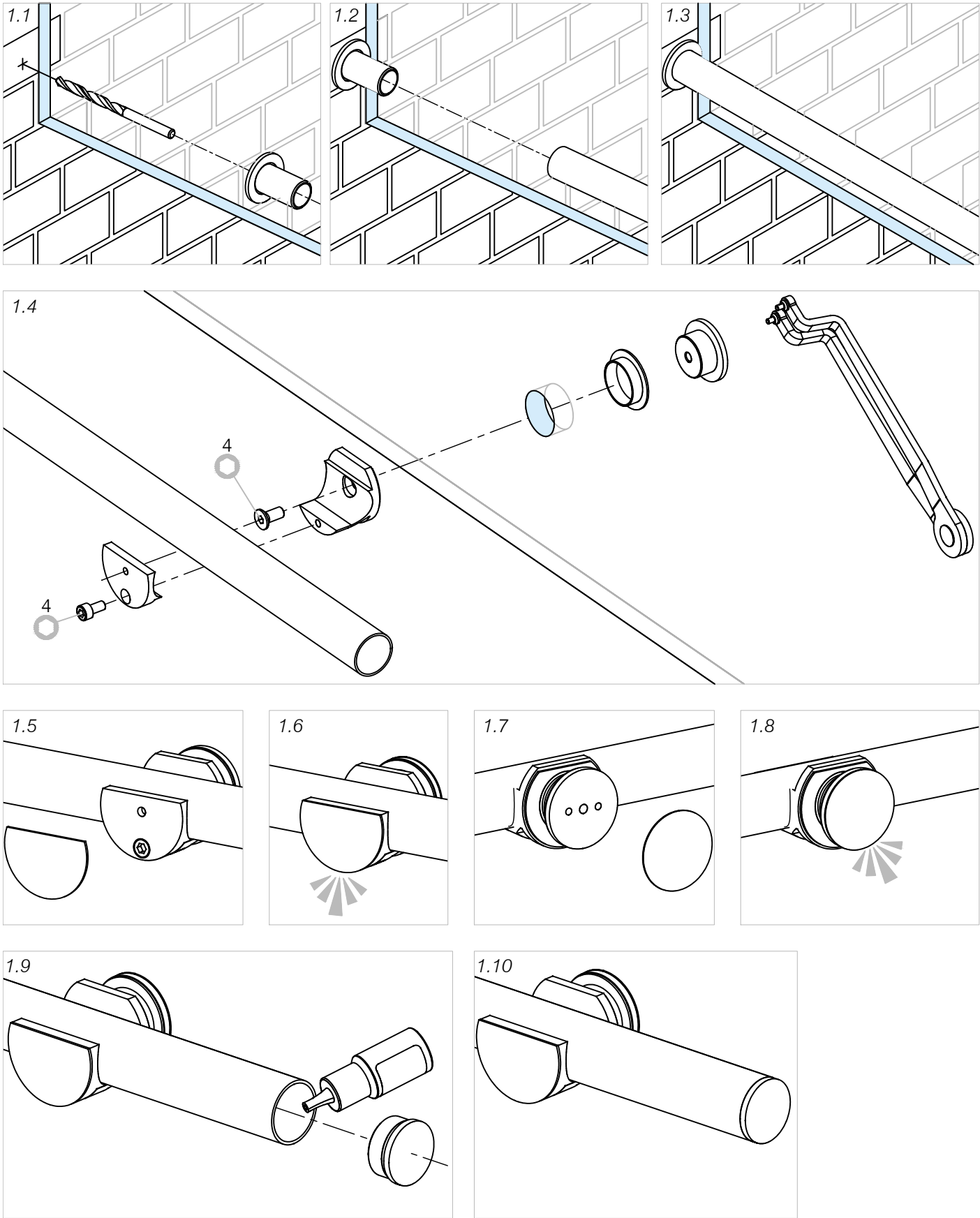

Nur Glas/Glas Montage Only glass/glass installation

Art. 29.5131.253.12
Art. 29.5131.253.26

Wichtig: Vor der Montage das Glas im Bereich der Klemmfläche und Glasbohrung reinigen.
Wir empfehlen G-Fittings Glasreiniger art. 91.1800.000.00 - (Keine Verdünnung/Lösemittel verwenden!)

Important: The glass clamping and drill hole area must be cleaned before installation.
We recommend G-Fittings glass cleaner art. 91.1800.000.00 - (Do not use thinners/solvents)!

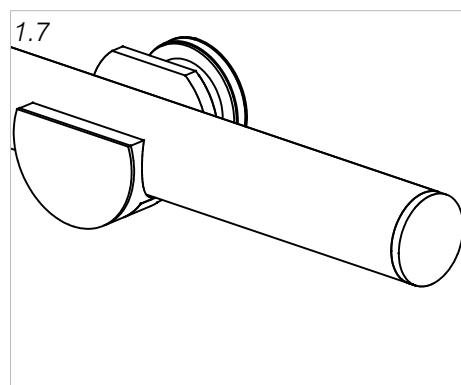
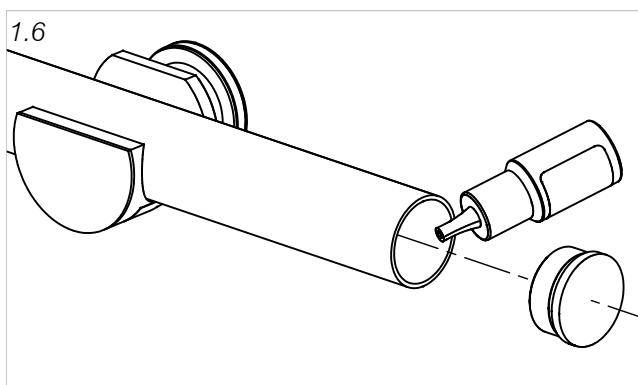
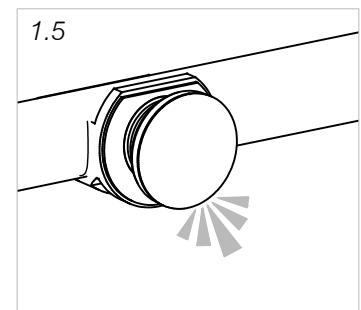
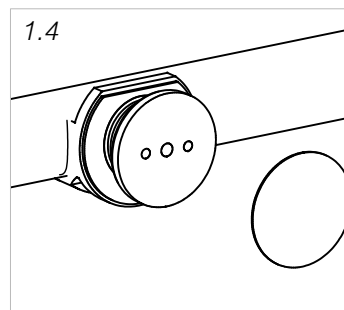
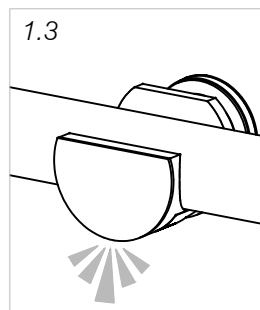
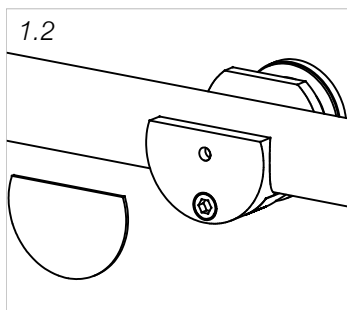
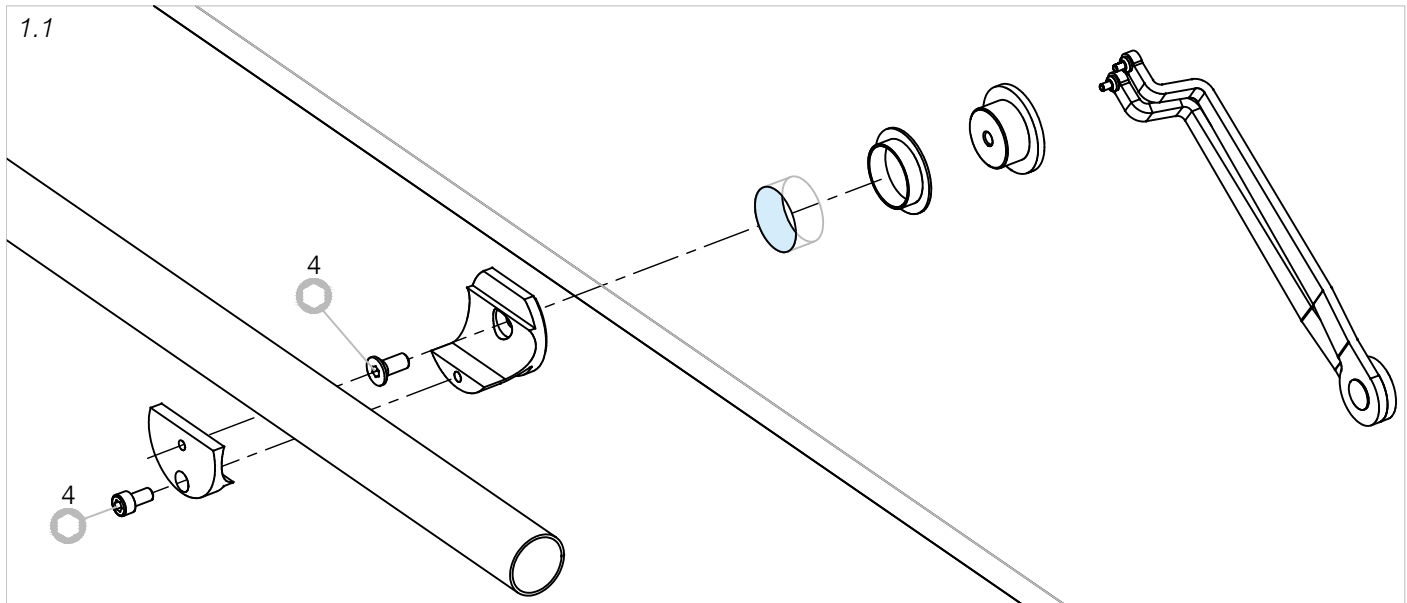

Art. 29.5131.251.12	Art. 29.5131.251.26
Art. 29.5131.252.12	Art. 29.5131.252.26
Art. 29.5131.253.12	Art. 29.5131.253.26

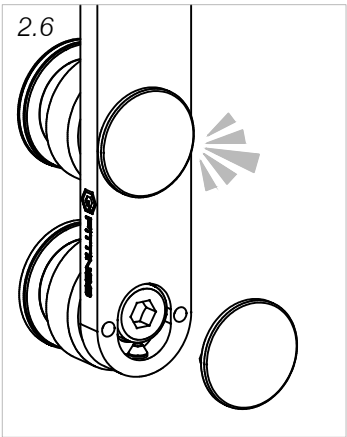
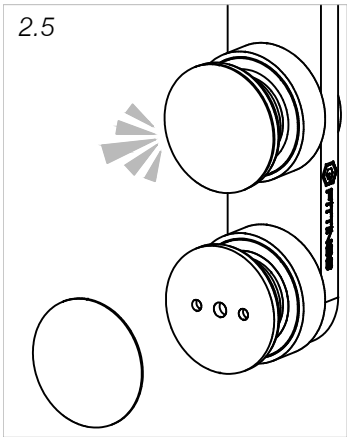
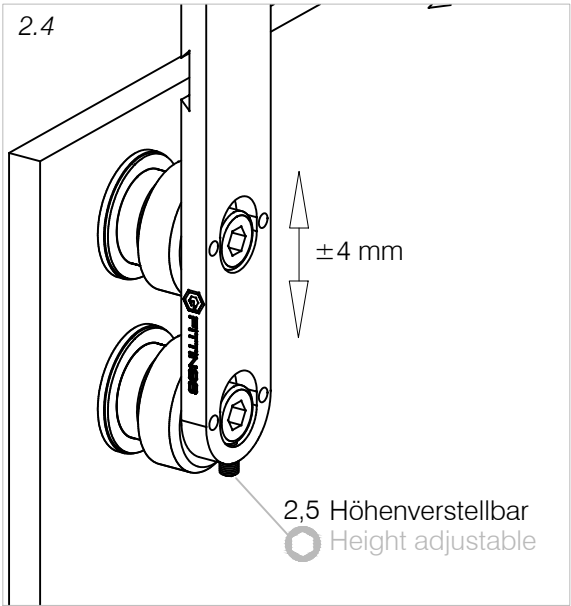
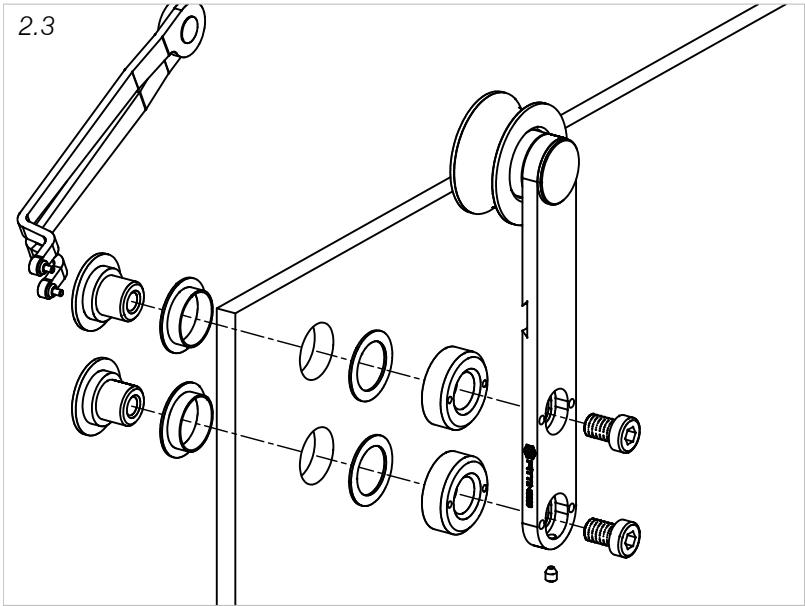
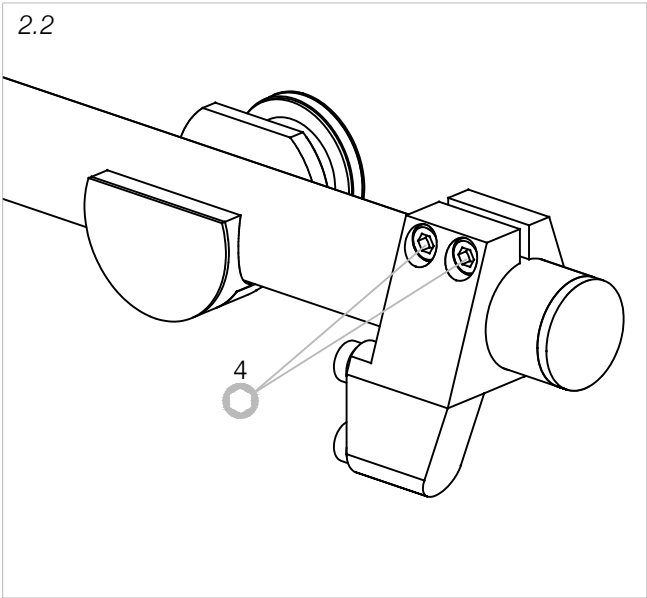
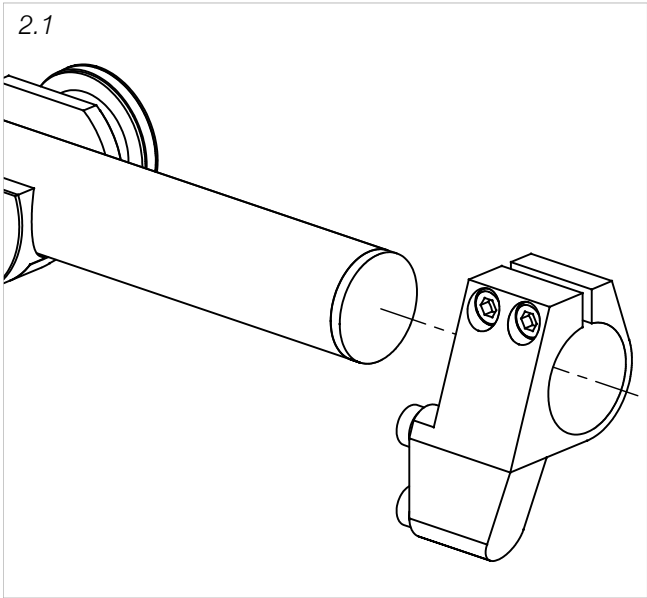

Art. 29.5131.251.12

Art. 29.5131.251.26

Art. 29.5131.252.12

Art. 29.5131.252.26

Art. 29.5131.253.12

Art. 29.5131.253.26

Stand 02.2022

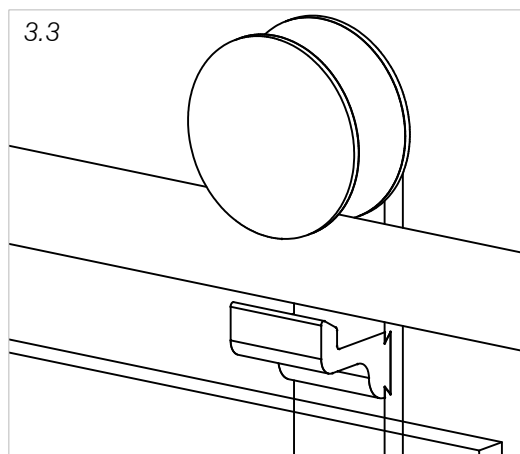
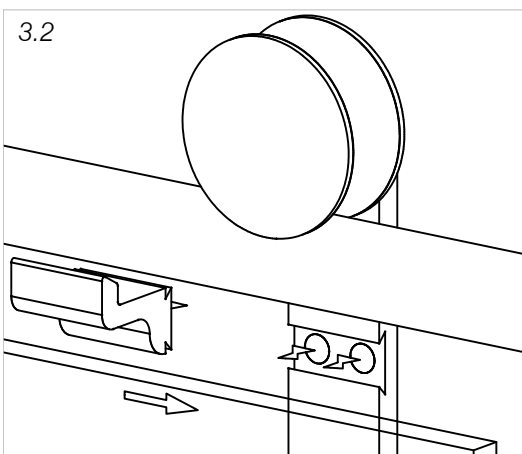
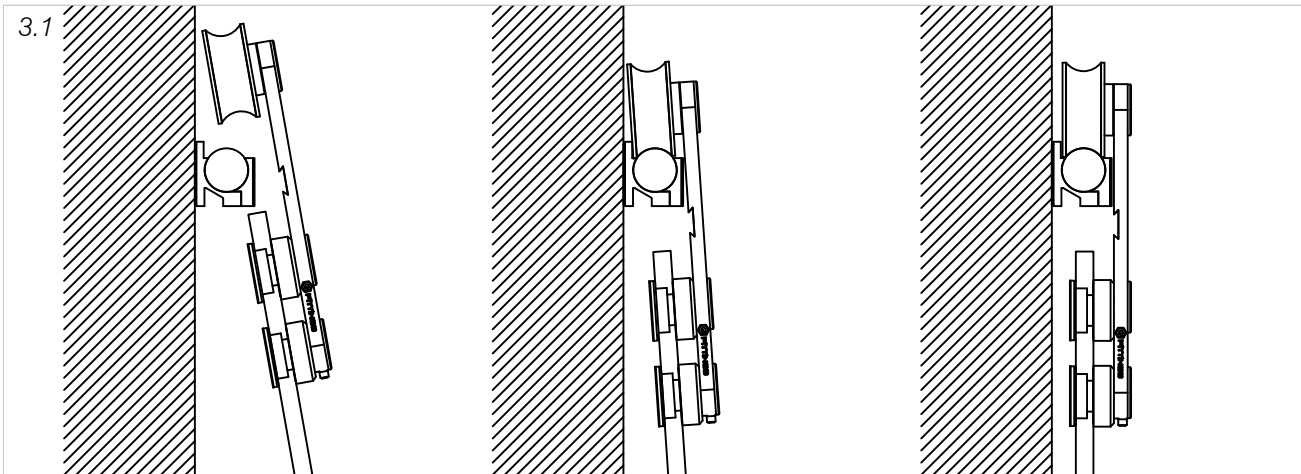

Werkzeuglose Montage von
Anti-Lift,
dank verbauter
Magnettechnologie

Toolless installation
of Anti-Lift, thanks
to built-in magnet technology

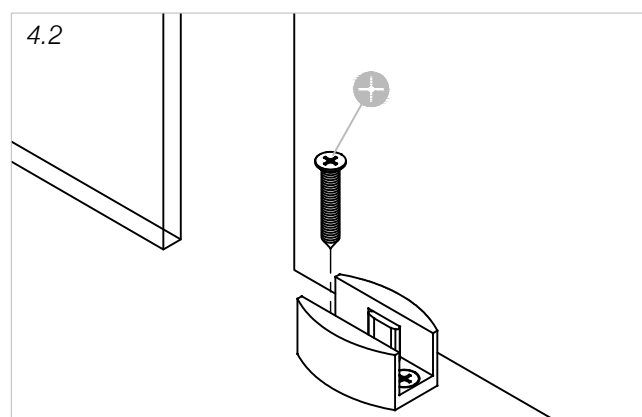
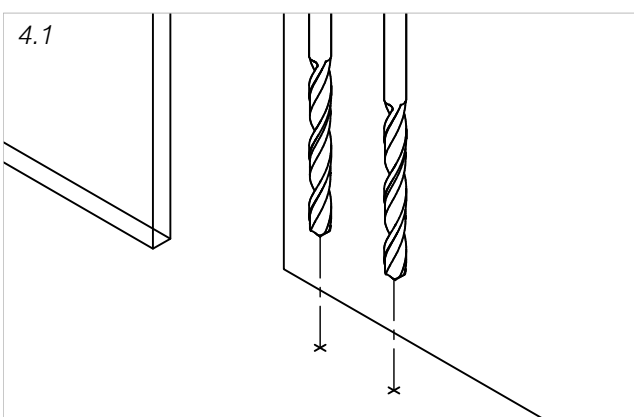

G-FITTINGS GmbH

Marie-Curie-Straße 16-18
46446 Emmerich am Rhein
T +49 (0)2822 962 0
F +49 (0)2822 962 221
E sales@g-fittings.com