

Technische Daten:
Türscharnier - CASSIE

Datasheet:
Door hinge - CASSIE

Art. 77452241000-20
Art. 77452241000-26
Art. 77452241000-46

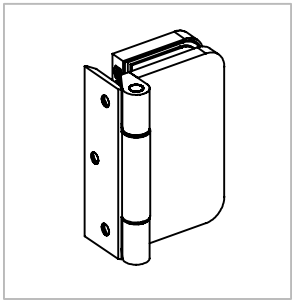

Ausführung:
Options:

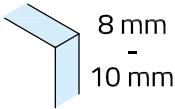
 8 mm
-
10 mm

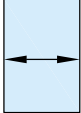
 1000 mm
max.

 50 kg max.

Material:	Aluminium	Gewicht: / Weight: 0,225 kg		
Material:	aluminium			
Oberflächen:	Edelstahl-Design	Anthrazit-Design	Silber matt eloxiert	
Finish:	Stainless steel design	Anthracite design	silver matt anodized	

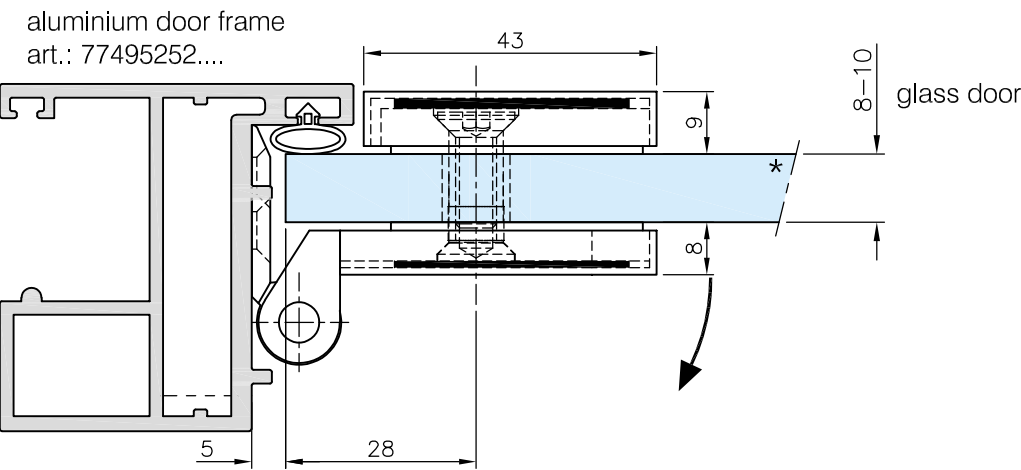
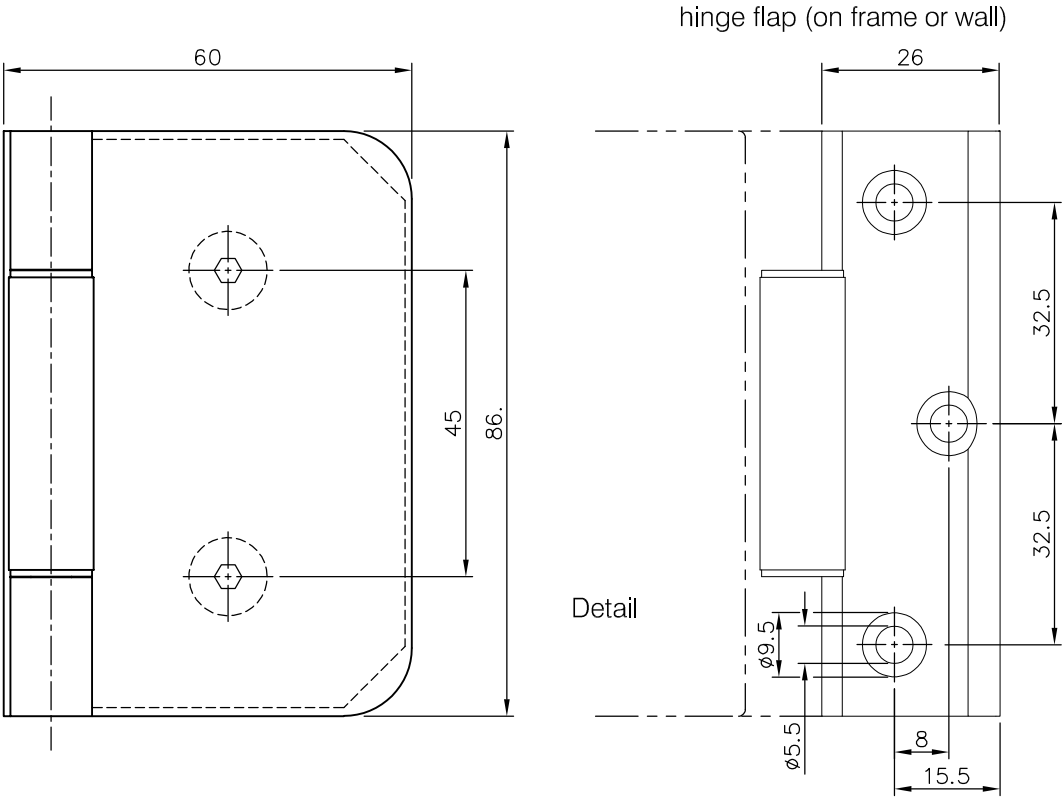

Art. 77452241000-20
Art. 77452241000-26
Art. 77452241000-46

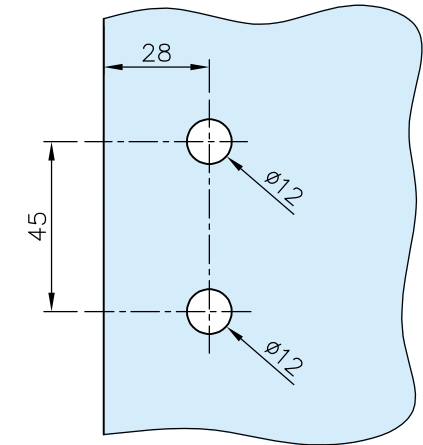

glass cutout

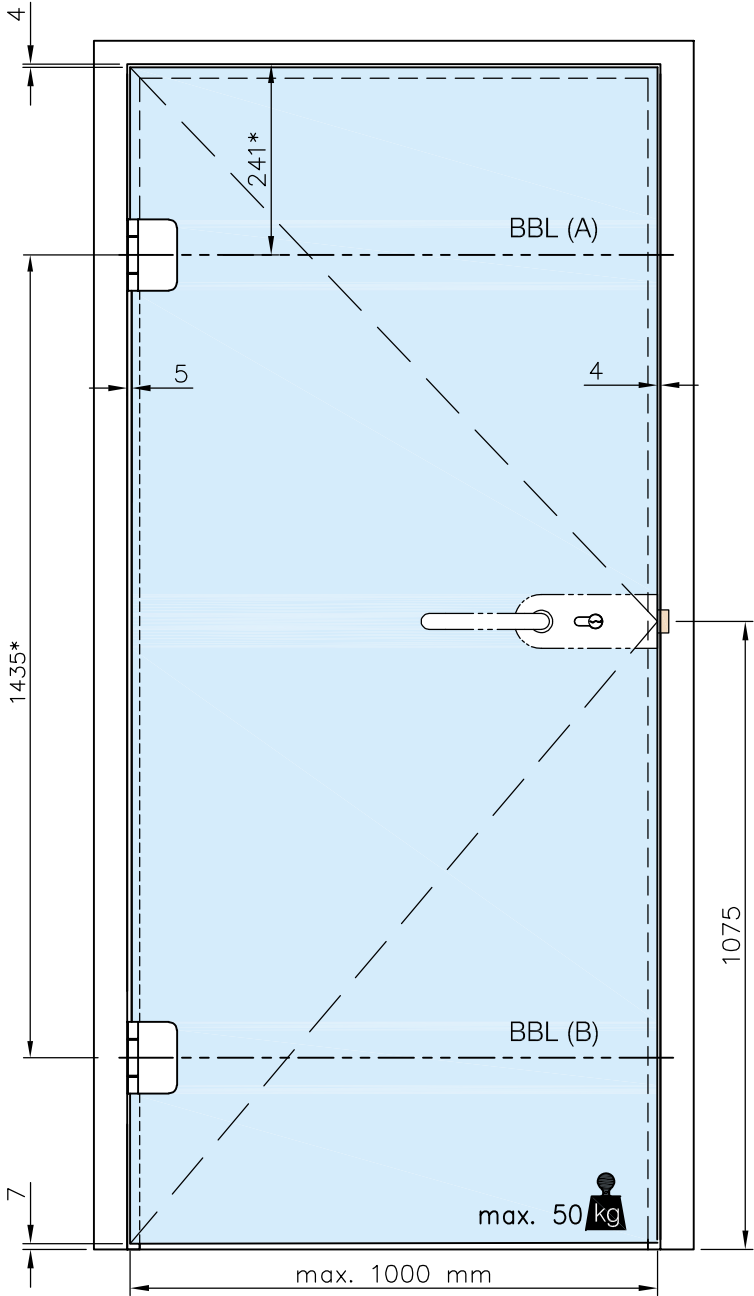

Empfehlungsmaße entsprechend *DIN 18268		
Glastürhöhe Glass door height	Abstand Zargenfalz - BBL(A) distance frame rebate - BBL(A)	Abstand BBL(A) - BBL(B) distance BBL(A) - BBL(B)
1860 mm - 2110 mm	241 +1 mm	1435 mm ±0,5 mm
2111 mm - 2235 mm	241 +1 mm	1560 mm ±0,5 mm
2236 mm - 2360 mm	241 +1 mm	1685 mm ±0,5 mm

Art. 77452241000-20
Art. 77452241000-26
Art. 77452241000-46

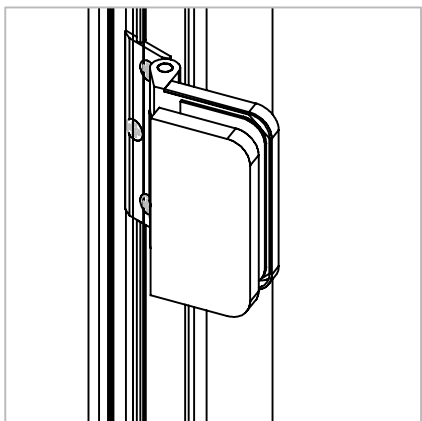
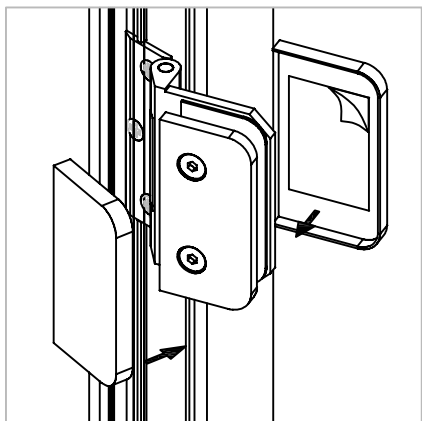
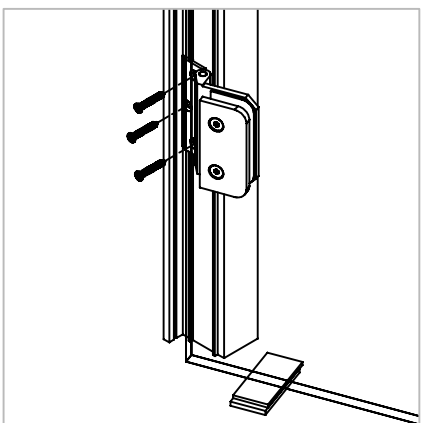
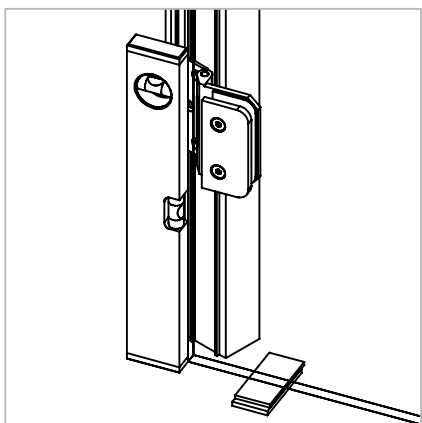
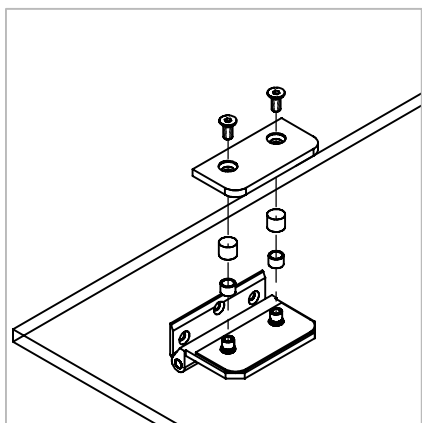
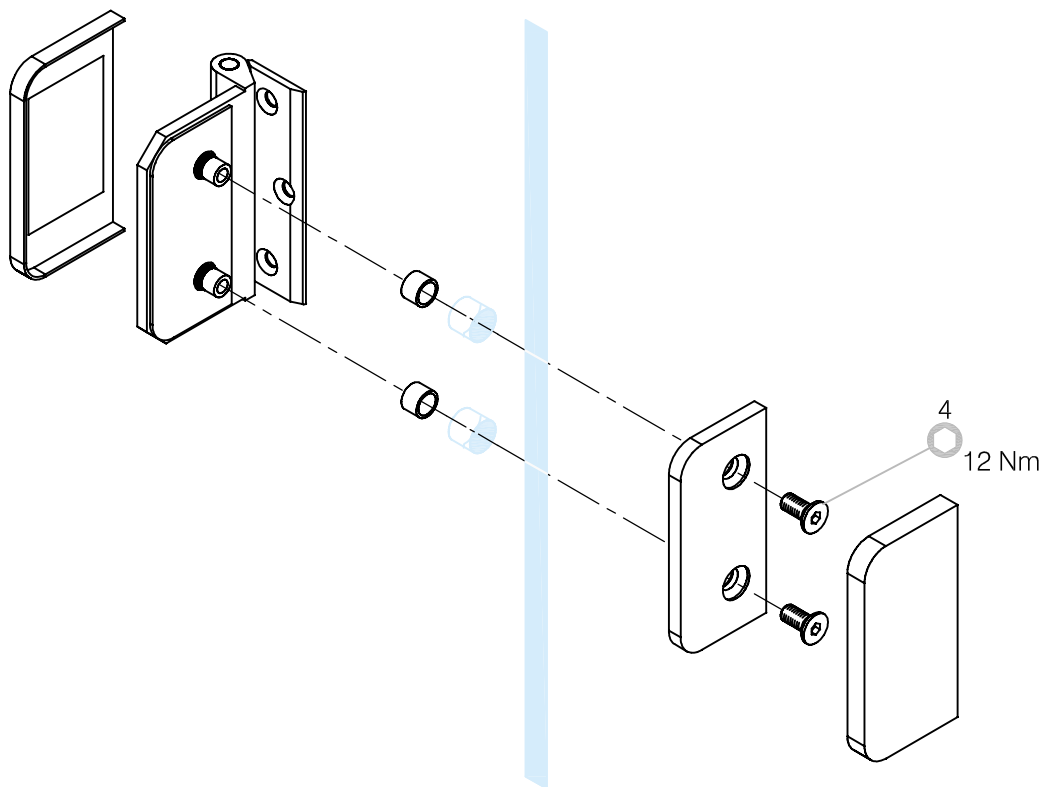

Art. 77452241000-20
Art. 77452241000-26
Art. 77452241000-46

Detail Aluminium Zarge:
Detail aluminium frame:

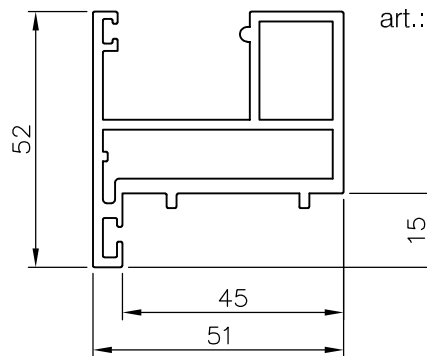
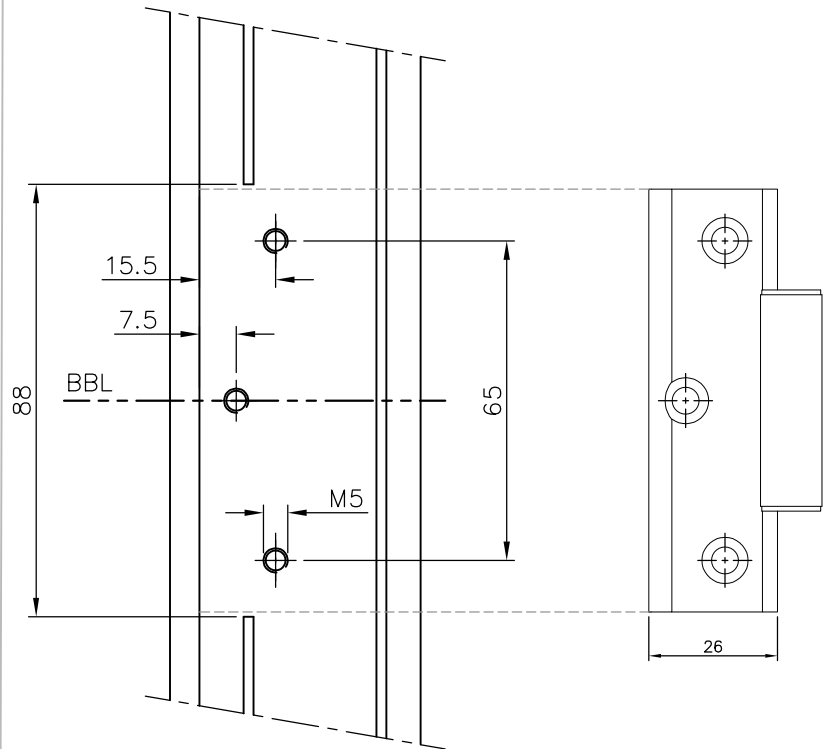
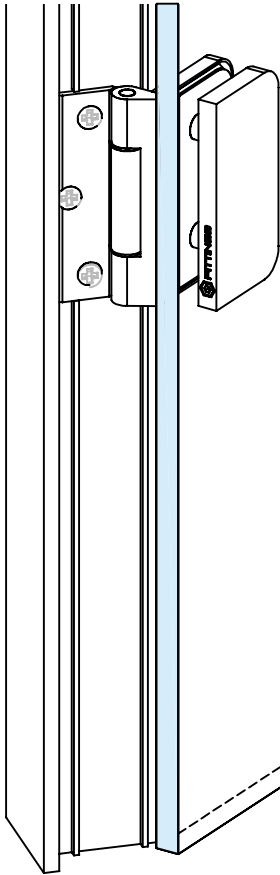

aluminium door frame
art.: 77495252....

G-FITTINGS GmbH

Marie-Curie-Straße 16-18
46446 Emmerich am Rhein
T +49 (0)2822 962 0
F +49 (0)2822 962 221
E sales@g-fittings.com