

Technische Daten: Türscharnier - ANNEMARTHE

Datasheet:
Door hinge - ANNEMARTHE

Art. 77452703000-10

Art. 77452703000-12

Art. 77452703000-26

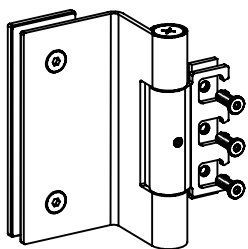

Ausführung:
Options:

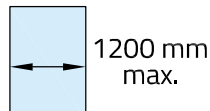
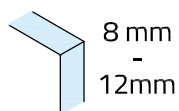

Material: V2A
Material: Stainless steel AISI 304

Gewicht: / Weight: 0,615 kg

Oberflächen: Edelstahl-Design
Finish: Stainless steel design

Chrom-Design
Chrome design

Anthrazit-Design
Anthracite design

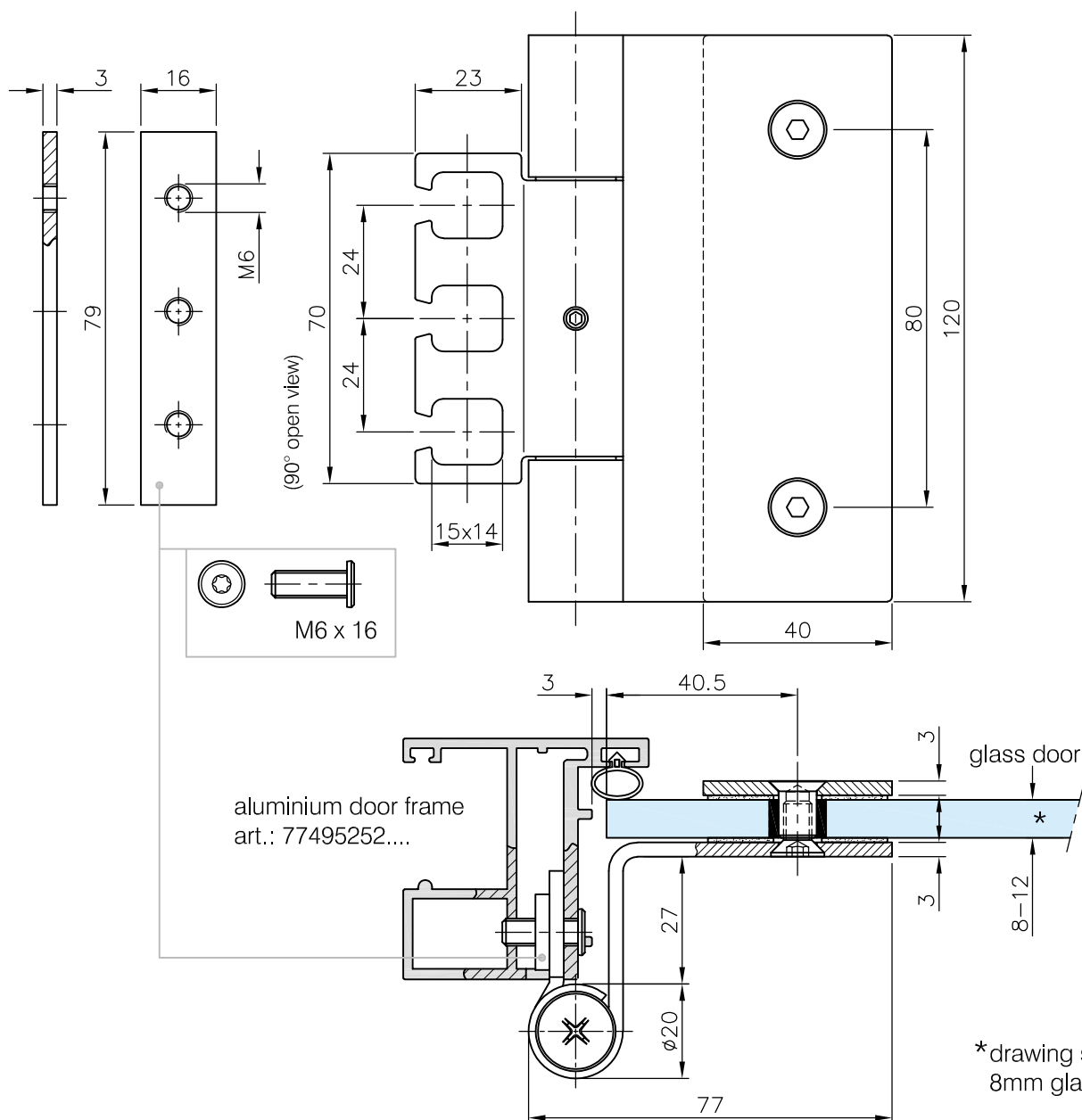

Art. 77452703000-10
Art. 77452703000-12
Art. 77452703000-26

Stand 06.2019

Glasbearbeitung:
Glass preparation:

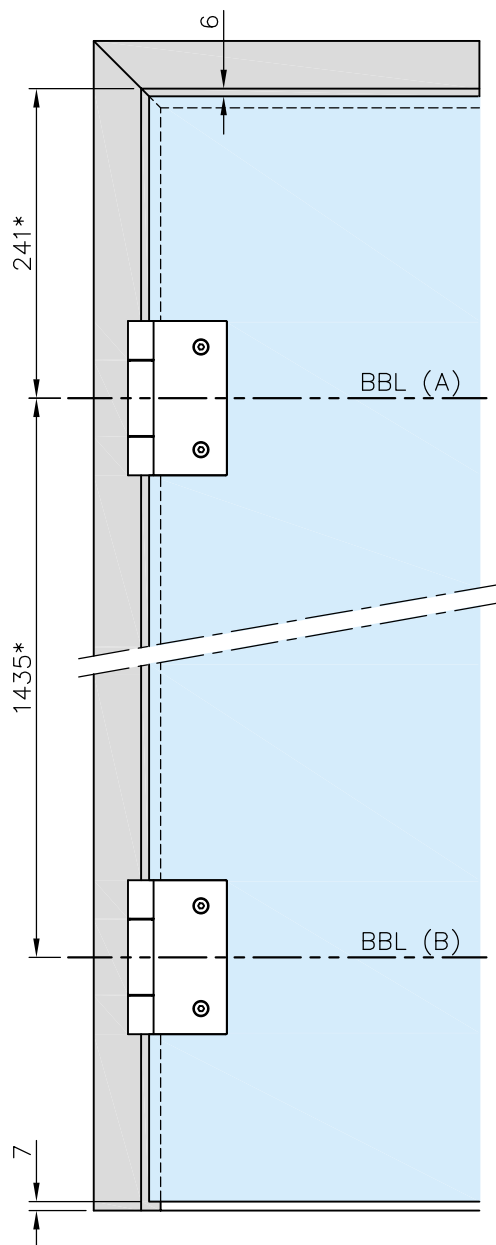
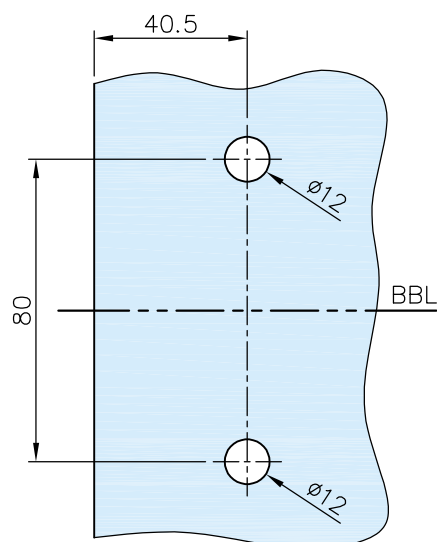

| Empfehlungsmaße entsprechend *DIN 18268 Recommended dimensions according to *DIN 18268 | | |
|---|---|---|
| Glastürhöhe Glass door height | Abstand Zargenfalz - BBL(A) distance frame rebate - BBL(A) | Abstand BBL(A) - BBL(B) distance BBL(A) - BBL(B) |
| 1860 mm - 2110 mm | 241 +1 mm | 1435 mm ±0,5 mm |
| 2111 mm - 2235 mm | 241 +1 mm | 1560 mm ±0,5 mm |
| 2236 mm - 2360 mm | 241 +1 mm | 1685 mm ±0,5 mm |

Art. 77452703000-10
Art. 77452703000-12
Art. 77452703000-26

Detail Aluminium Zarge:
Detail aluminium frame:

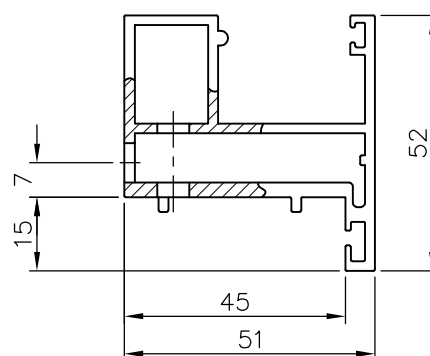
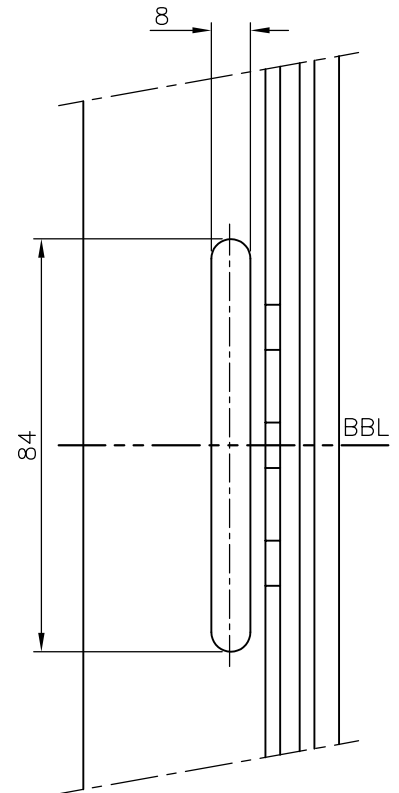
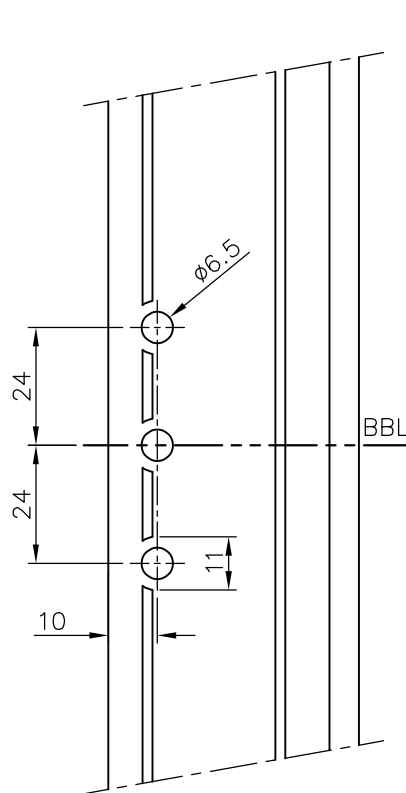
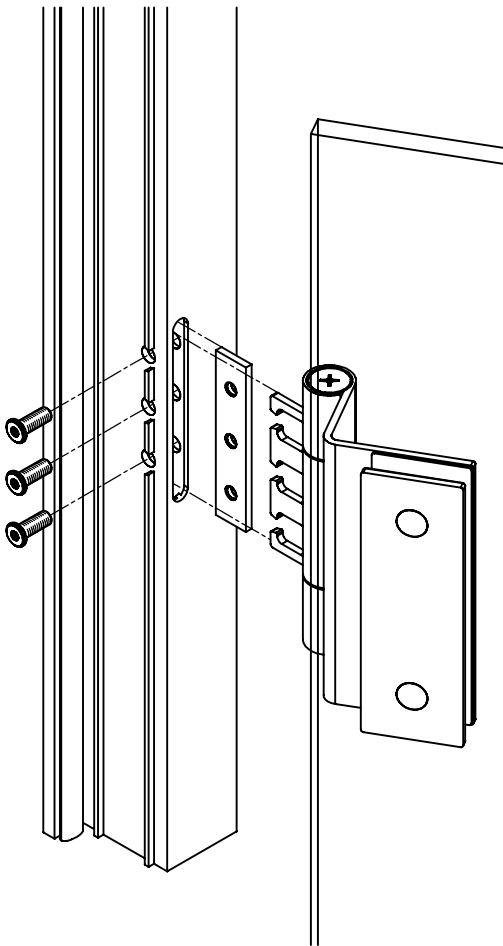

aluminium door frame
art.: 77495252....

G-FITTINGS GmbH

Marie-Curie-Straße 16-18
46446 Emmerich am Rhein
T +49 (0)2822 962 0
F +49 (0)2822 962 221
E sales@g-fittings.com